



## REMOTE CONTROLLER INSTRUCTIONS

Thank you very much for purchasing this Air Conditioner. Please read this instructions carefully before using this appliance and keep this manual for future reference.

# ***Remote controller Instructions***

## ***( L1-02/L1-12)***

Remote controller .....	1
Operation instructions	
Operation modes .....	3
Airflow direction control .....	4
Smart mode .....	5
Clock button .....	6
Super mode .....	7
Timer mode .....	8
Quiet mode .....	8
Economy mode .....	9
Ifeel mode .....	9
Dimmer button .....	9
Sleep mode .....	10

# Remote controller

## Remote controller

The remote controller transmits signals to the system.

### SMART (invalid for some models)

Used to enter fuzzy logic operation directly, regardless of the unit is on or off.

### POWER

The appliance will be started when it is energized or will be stopped when it is in operation, if you press this button.

### SUPER

Used to start or stop the fast cooling/heating. (Fast cooling operates at high fan speed with 16°C (61°F) set temp automatically; Fast heating operates at auto fan speed with 30°C (86°F) set temp automatically)

### IFEEL

Used to set IFEEL mode operation. Press it once, the IFEEL function will be started. Press it again, the IFEEL function will be shut off.

### SWING (invalid for some models)

Used to stop or start vertical adjustment louver swinging and set the desired up/down airflow direction.

### CLOCK

Used to set the current time.

### QUIET (invalid for some models)

Used to set or cancel Quiet Mode operation.

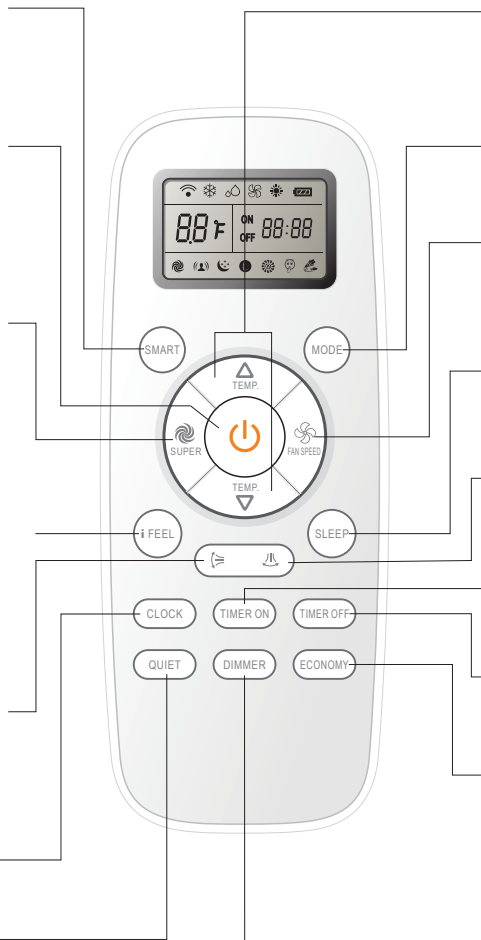

### TEMP + -

Used to adjust the room temperature and the timer, also real time.

### MODE

Press this button to select the operation mode.

### FAN

Used to select fan speed in sequence auto, high, medium or low.

### SLEEP

Used to set or cancel Sleep Mode operation.

### SWING (invalid for some models)

Used to stop or start Horizontal adjustment louver swinging and set the desired left/right airflow direction.

### TIMER ON

Used to set or cancel the timer operation.

### TIMER OFF

Used to set or cancel the timer operation.

### ECONOMY (invalid for some models)

Used to set or cancel Economy Mode operation.

### DIMMER (invalid for some models)

When you press this button, all the display of indoor unit will be closed. Press any button to resume display.

## Indication symbols on LCD:

	Cooling indicator		Auto fan speed		Sleep 1 indicator		Quiet indicator		Signal transmit
	Dry indicator		High fan speed		Sleep 2 indicator		Smart indicator		Battery power indicator
	Fan only indicator		Medium fan speed		Sleep 3 indicator		Economy indicator	ON 88:88	Display set timer
	Heating indicator		Low fan speed		Sleep 4 indicator		Super indicator	OFF 88:88	Display current time
							Ifeel	88°F	Display temperature

Note: Each mode and relevant function will be further specified in following pages.

# Remote controller

## Remote controller

### ◆ How to Insert the Batteries

1. Remove the battery cover according to the arrow direction.
2. Insert new batteries making sure that the (+) and (-) of battery are matched correctly.
3. Reattach the cover by sliding it back into position.

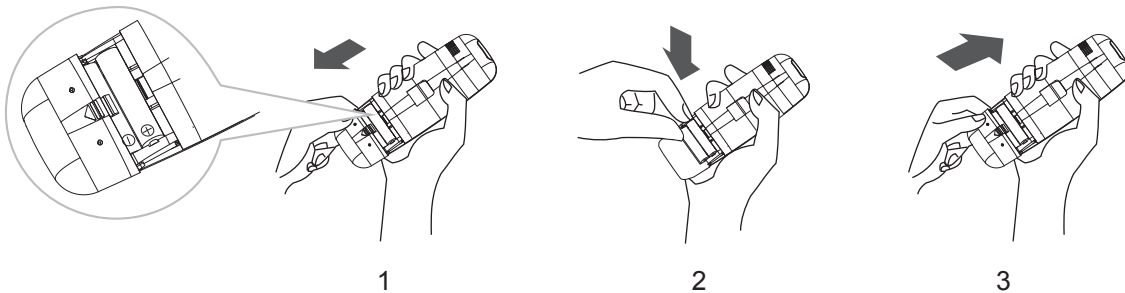

**Note:**

- Use 2 LR03 AAA(1.5volt) batteries. Do not use rechargeable batteries. Replace batteries with new ones of the same type when the display becomes dim.

### ◆ Storage and Tips for Using the Remote Controller

The remote controller may be stored mounted on a wall with a holder.

**Note:** The remote controller holder is an optional part.

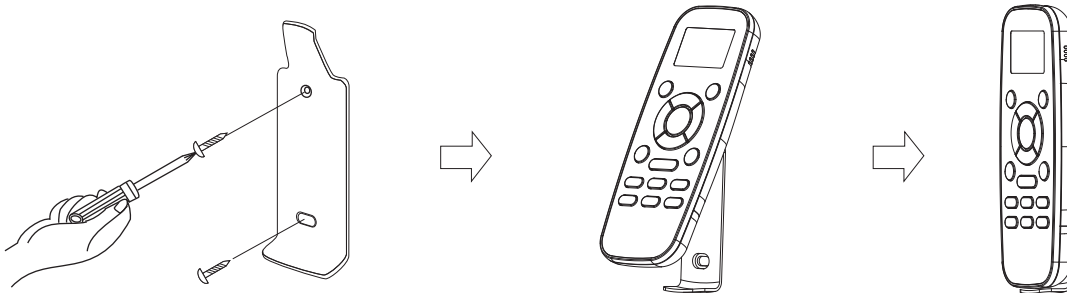

### ◆ How to Use

To operate the room air conditioner, aim the remote controller to the signal receptor. The remote controller will operate the air conditioner at a distance of up to 7m when pointing at signal receptor of indoor unit.

#### ⚠ CAUTIONS

For appropriate signal transmission between remote controller and indoor unit, keep the signal receiver away from the following items:

- Direct sunlight or other strong lights or heat
- Flat panel television screen or other electrical appliances that react to the remote controller

Additionally, the air conditioner will not operate if curtains, doors or other materials block the signals from the remote controller to the indoor unit. If the signal may not be transmitted properly, either move these materials or consult your local dealer.

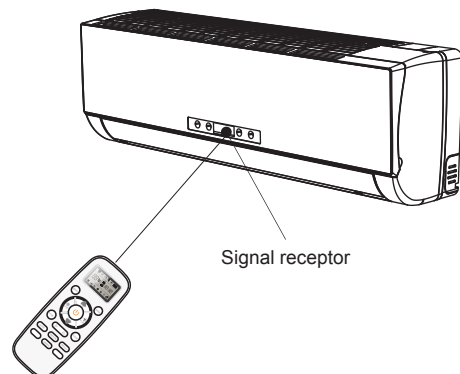

# Operation instructions

## Operation modes

### ◆ Selecting mode

Press  button once by once

**Result :** The operation modes changed in sequence:



☑ **Heating mode is NOT available for cooling only air conditioner.**

### ◆ FAN mode

Press  button once by once

**Result :** The fan speed is changed in sequence:

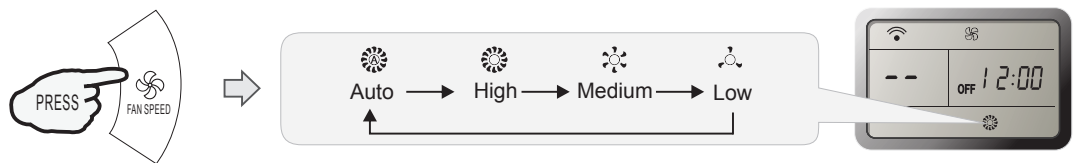

☑ **At "FAN ONLY" mode, only "High", "Medium" and "Low" are available.**  
**At "DRY" mode, Fan speed is set at "AUTO" automatically, "FAN" button is ineffective in this case.**

### ◆ Setting temperature

Press  button once

**Result :** Raise temperature setting by 1°C or 1°F

Press  button once

**Result :** Lower temperature setting by 1°C or 1°F

Range of available set temperature	
*HEATING, COOLING	16°C~30°C (61°F~86°F)
DRY	-7 ~ 7
FAN ONLY	unable to set

☑ **\*Note: Press and hold "MODE" button and "TEMP DOWN" button together for 3 seconds will alternate the temperature display between the °C and °F scale.**

**\*Note: Heating mode is NOT available for cooling only models.**

**\*Note: At "Dry" mode, a decrease or rise of up to 7°C can be set with Remote controller if you still feel uncomfortable.**

### ◆ Turning on

Press  button.

**Result :** The RUN indicator of the indoor unit lights up.

**SWING, SMART, TIMER ON, TIMER OFF, CLOCK, SLEEP and SUPER operation modes will be specified in the following pages.**

- ☑ • **Changing modes during operation, sometimes the unit does not response at once. Wait 3 minutes.**
- **During heating operation, air flow is not discharged at the beginning. After 2–5 minutes, the air flow will be discharged until temperature of indoor heat exchanger rises.**
- **Wait 3 minutes before restarting the appliance.**

# Operation instructions

## Airflow direction control (invalid for some models)

Vertical airflow(Horizontal airflow) is automatically adjusted to a certain angle in accordance with the operation mode after turning on the unit.

Operation mode	Direction of airflow
COOLING, DRY	horizontal
*HEATING, FAN ONLY	downward

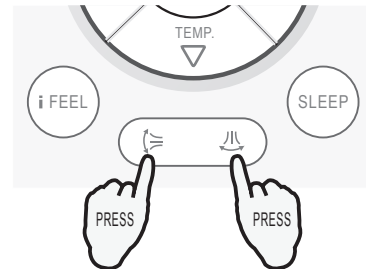

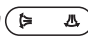
The direction of airflow can be also adjusted to your own requirement by pressing the "  " button of the remote controller.

*\*Heating mode is only available for heat pump models.*

### ◆ Vertical airflow control (with the remote controller)

Using remote controller to set various angles of flow or specific angle as you like.

Press "  " button once.

**Result :** The vertical adjustment louver will swing up and down automatically.



Press "  " button again .

**Result :** The louvers swing to a suitable angle as desired.





### ◆ Horizontal airflow control (with the remote controller)

Using remote controller to set various angles of flow or specific angle as you like.

Press "  " button once.

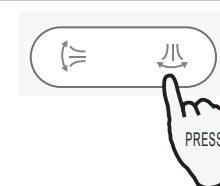
**Result :** The horizontal adjustment louver will swing left and right automatically.



Press "  " button again .

**Result :** The louvers swing to a suitable angle as desired.

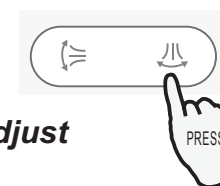

**NOTE:** If the unit doesn't have four ways airflow function, you can adjust horizontal airflow by yourself.(invalid for some models)

**A** Do not turn the vertical adjustment louvers manually, otherwise malfunction may occur. If that happens, turn off the unit first and cut off the power supply, then restore power supply again.

**B** It is better not to let the vertical adjustment louver tilt downward for a long time at COOLING or DRY mode to prevent condensed water from dripping.

# Operation instructions

## SMART mode (invalid for some models)

### ◆ How to set SMART mode?

Press the  button.

**Result :** Enters **SMART** mode (fuzzy logic operation) directly regardless of the unit is on or off. Temperature and fan speed are automatically set based on the actual room temperature.

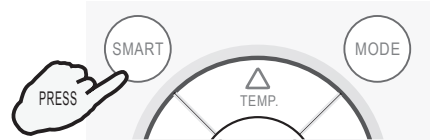

For the split-type models, such as wall-mounted air conditioners and some floor-standing air conditioners, their operation mode and set temperature should be determined based on the indoor temperature.

#### Heat pump models

Indoor temperature	Operation mode	Target temperature
21°C (70°F) or below	HEATING	22°C (72°F)
21°C-23°C (70°F-73°F)	FAN ONLY	
23°C-26°C (73°F-79°F)	DRY	Room temperature decrease 2°C ( 2°F) after operate for 3 minutes
Over 26°C (79°F)	COOLING	26°C (79°F)

#### Cooling only models

Indoor temperature	Operation mode	Target temperature
23°C (73°F) or below	FAN ONLY	
23°C-26°C (73°F-79°F)	DRY	Room temperature decrease 2°C ( 2°F) after operate for 3 minutes
Over 26°C (79°F)	COOLING	26°C (79°F)

For commercial air conditioner products, such as cassette type air conditioners, duct type air conditioners, ceiling & floor air conditioners and some floor-standing air conditioners, their operation mode should be determined based on the difference between the indoor temperature and set temperature.

#### Heat pump models

Indoor temperature	Operation mode	Target temperature
Below T-3°C (3°F)	HEATING	T
$T-3^{\circ}\text{C} (3^{\circ}\text{F}) \leq T_{\text{indoor}} \leq T+3^{\circ}\text{C} (3^{\circ}\text{F})$	FAN ONLY	T
Over T+3°C (3°F)	COOLING	T

#### Cooling only models

Indoor temperature	Operation mode	Target temperature
T+3°C (3°F) or below	FAN ONLY	T
Over T+3°C (3°F)	COOLING	T

☑ **SMART** button is ineffective in **SUPER** mode.

☑ **ECONOMY** button is ineffective in **SMART** mode.



☑ Press **MODE** button cancel **SMART** mode.

**Note:** Temperature, airflow and direction are controlled automatically in **SMART** mode. However, For the on/off, you can choose from -2 to 2, for the inverter you can choose from -7 to 7. if you still feel uncomfortable.

# Operation instructions

## SMART mode (invalid for some models)

### ◆ What you can do in SMART mode?

Your feeling	Button	Adjust
Uncomfortable because of unsuitable air flow volume.		Indoor fan speed alternates among Auto, High, Medium and Low each time this button is pressed.
Uncomfortable because of unsuitable flow direction.		Press it once, the vertical adjustment louver (horizontal adjustment louver) swings to change vertical airflow direction (horizontal airflow direction). Press it again, swings stops.

### ◆ How to cancel the SMART mode?

Press the  button.

**Result :** The SMART mode will be cancelled.

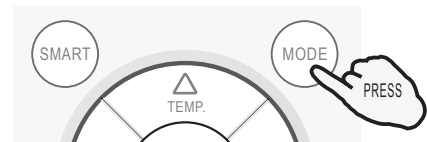

## CLOCK button

### ◆ How to adjust the real time?

1. Press  button.

**Result :** The time flashes on the LCD.



2. Press  and  buttons.

**Result :** Once to increase or decrease the time setting by 1 minute.  
One and a half seconds to increase or decrease the time setting by 10 minute.  
For a longer time to increase or decrease the time by 1 hour.

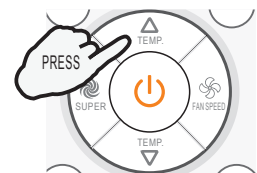

3. Press  button again.

**Result :** The real time is set.





# Operation instructions

## SUPER mode

**SUPER** mode is used to start or stop fast cooling or heating. In **SUPER** mode, the super indicator will display on LCD.

**SUPER** mode can be set when the appliance is in operation or energized.  
In **SUPER** mode, you can set temperature, airflow direction or timer.

### ◆ How to set **SUPER** mode?

Press  button at the cooling, dry or fan only mode.

**Result :** At high fan speed ,the set temperature automatically to 16°C(61°F).

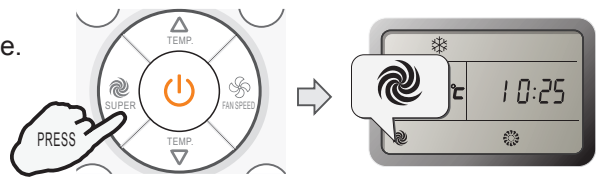

Press  button at the heat mode.

**Result :** At auto fan speed ,the set temperature automatically to 30°C(86°F).

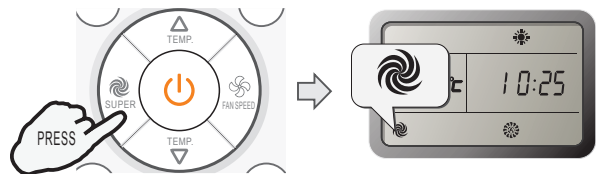

### ◆ How to cancel **SUPER** mode?

Press **SUPER** , **MODE**, **FAN**, **ON/OFF** or **SLEEP** button.

**Result :** The display return to the original mode.  
Escape from **SUPER** mode.

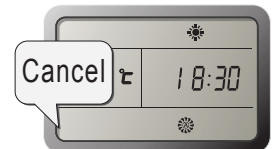

#### **Note:**

**SMART** button is not available in **SUPER** mode.

**ECONOMY** button is ineffective in **SUPER** mode.

The Appliance will continue working in **SUPER** mode, if you don't escape from it by pressing any of the buttons mentioned above.

Heating is **NOT** available for cooling only air conditioner.

For the first generation of products, you can't set temperature in super mode, but you can press **TEMPERATURE SETTING** button to escape from super mode.

# Operation instructions

## Timer mode

It is convenient to set the timer on with **TIMER ON** buttons when you go out in the morning to achieve a comfortable room temperature at the time you get home. You can also set timer off at night to enjoy a good sleep.

### ◆ How to set **TIMER ON**?

1. Press  button.

**Result :** "ON 12:00" flashes on the LCD.

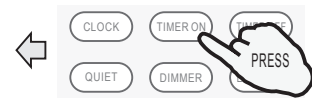

2. Press the  or  button.

**Result :** Once to increase or decrease the time setting by 1 minute.  
One and a half seconds to increase or decrease the time setting by 10 minute.  
For a longer time to increase or decrease the time by 1 hour.

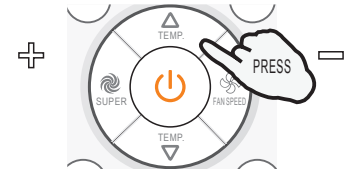

3. When your desired time displayed on LCD, press the **TIMER ON** button and confirm it.

**Result :** A "beep" can be heard.  
"ON" stops flashing.  
The **TIMER** indicator on the indoor unit lights up. (invalid for some models)

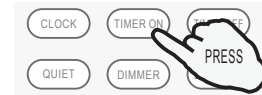

4. After the set timer displayed for 5 seconds the clock will be displayed on the LCD of the remote controller instead of set timer.

### ◆ How to cancel **TIMER ON**?

Press the  button again.

**Result :** A "beep" can be heard and the indicator disappears, the time on mode has been canceled.



**Note:** It is similar to set **TIMER OFF**, you can make the appliance switch off automatically at your desired time.

## QUIET mode (invalid for some models)

In this mode, the air conditioner will work with low noise performance.

**Note:** Press **MODE.FAN.SMART.SUPER** button cancel **QUIET** mode.

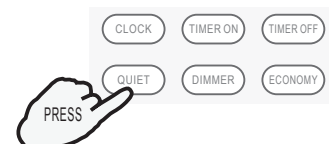

# Operation instructions

## **ECONOMY mode** (invalid for some models)

In this mode, the air conditioner will bring you energy saving performance by lower running currency.

**Note:**

*ECONOMY button is ineffective in SMART and SUPER mode.*

Press ON/OFF , MODE ,TEMP ▲ ,TEMP ▼ , FAN , SLEEP , QUIET or ECONOMY button cancel ECONOMY mode.

## **IFEEL mode**

The temperature sensor built in remote controller is activated.It can sense its surrounding temperature,and transmit the signal back the unit,the unit can adjust the temperature so as to provide maximum comfort.

### ◆ How to set IFEEL mode?

Press the  button once.

Result : The transmit signal in the display will appear, and the IFEEL function will be started.

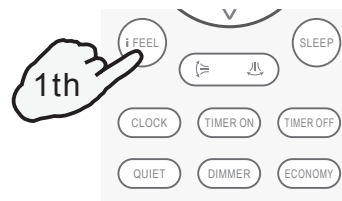

### ◆ How to cancel IFEEL mode ?

Press the  button once again.

Result : The transmit signal in the display will disappear, and the IFEEL function will be shut off.



## **Dimmer button** (invalid for some models)

### ◆ How to set the DIMMER ?

Press the DIMMER button to turn off the light and the display in the unit.

**Note:**

*When the light is off, receive signal will turn on the light again.*



# Operation instructions

## SLEEP mode

SLEEP mode can be set in **COOLING**, **HEATING** or **DRYING** mode.

This function gives you a more comfortable environment for sleep.

- The appliance will stop operation automatically after operating for 8 hours.
- Fan speed is automatically set at low speed.

### ◆ How to set SLEEP mode ?

Each time  button is pressed.

**Result :** The operation mode is changed in sequence:



#### SLEEP mode 1:

- Set temperature will rise by 2°C(2°F) at most if the appliance operates in cooling mode for 2 hours constantly, then keeps steady.
- Set temperature will decrease by 2°C(2°F) at most if the appliance operates in heating mode for 2 hours constantly, then keeps steady.

#### SLEEP mode 2:

- Set temperature will rise by 2°C(2°F) if the appliance operates in cooling mode for 2 hours constantly, decrease by 1°C(1°F) after 6 hours, then decrease by 1°C(1°F) after 7 hours.
- Set temperature will decrease by 2°C(2°F) if the appliance operates in heating mode for 2 hours constantly, rise by 1°C(1°F) after 6 hours, then rise by 1°C(1°F) after 7 hours.

#### SLEEP mode 3:

- Set temperature will rise by 1°C(1°F) if the appliance operates in cooling mode for 1 hour, rise by 2°C(2°F) after 2 hours, then decrease by 2°C(2°F) after 6 hours, decrease by 1°C(1°F) after 7 hours.
- Set temperature will decrease by 2°C(2°F) if the appliance operates in heating mode for 1 hour, decrease by 2°C(2°F) after 2 hours, then rise by 2°C(2°F) after 6 hours, rise by 2°C(2°F) after 7 hours.

#### SLEEP mode 4:

- Set temperature will keeps steady.

**Note:** Press **SUPER**, **SMART**, **MODE** or **FAN** button cancel SLEEP mode.

**Note:** By pressing "Sleeping mode" four times, or selecting other modes like **SUPER**, **SMART**, OR **FAN**, you could cancel the sleeping function of those units without four sleeping curves.

**Note:** Heating is **NOT** available for cooling only air conditioner.

**Note:** Some SLEEP modes are not available for some models.